

Upgrade Other firmware versions for WI-R2

Note: only applicable from old web interface

Login web interface, Click **Advance Setting**>**System Setting** then Upload the bin file under the firmware upgrade interface.

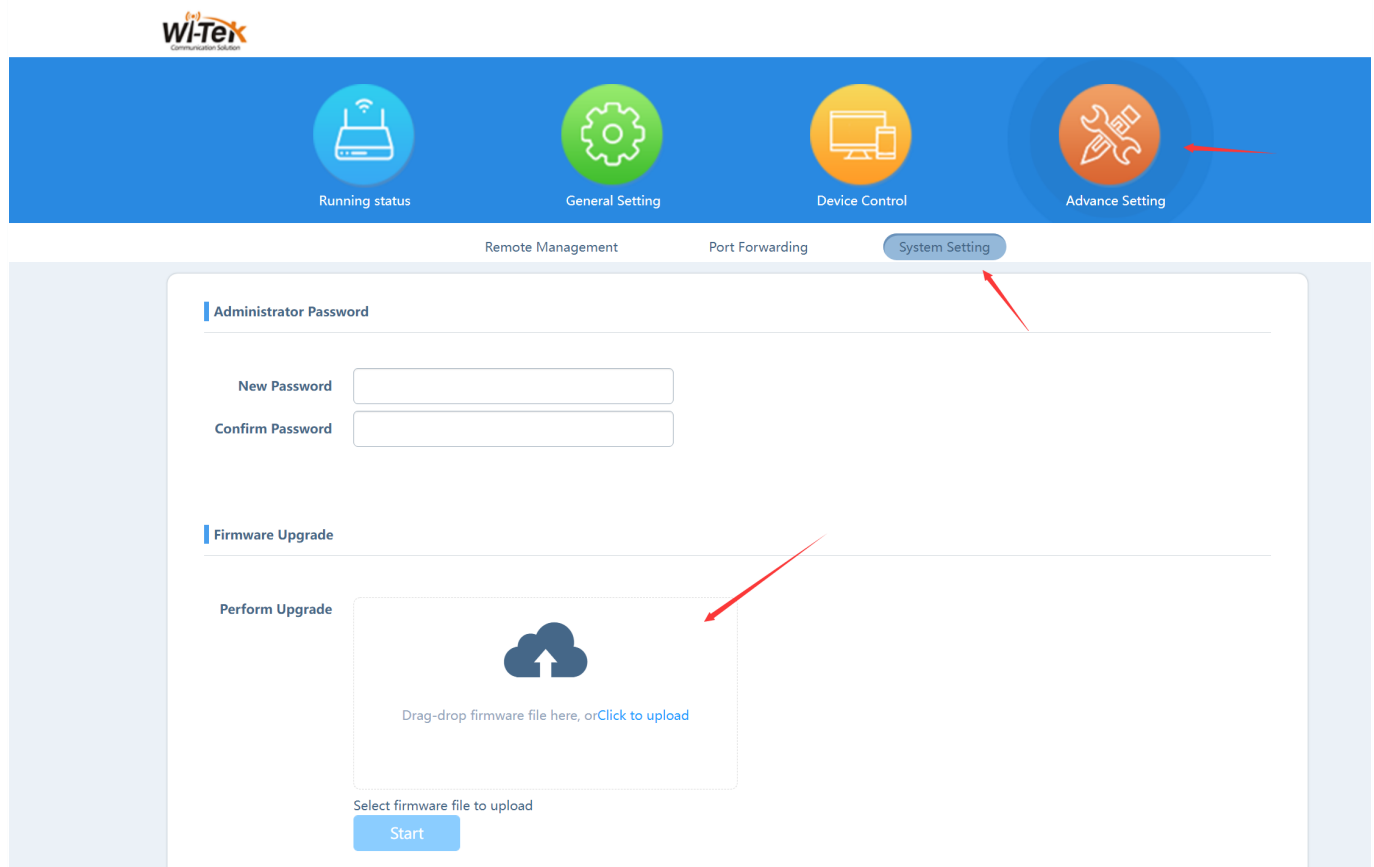

The screenshot displays the Wi-Tex web interface. At the top, there is a blue navigation bar with four icons: a router for 'Running status', a gear for 'General Setting', a monitor and phone for 'Device Control', and a wrench and screwdriver for 'Advance Setting'. A red arrow points to the 'Advance Setting' icon. Below this bar is a sub-navigation bar with three tabs: 'Remote Management', 'Port Forwarding', and 'System Setting'. A red arrow points to the 'System Setting' tab. The main content area is divided into two sections. The first section, 'Administrator Password', contains two input fields for 'New Password' and 'Confirm Password'. The second section, 'Firmware Upgrade', contains a 'Perform Upgrade' area with a cloud and upload icon. A red arrow points to this area. Below the icon is the text 'Drag-drop firmware file here, or [Click to upload](#)'. At the bottom of this section is a 'Select firmware file to upload' label and a 'Start' button.

Firmware uploaded successfully

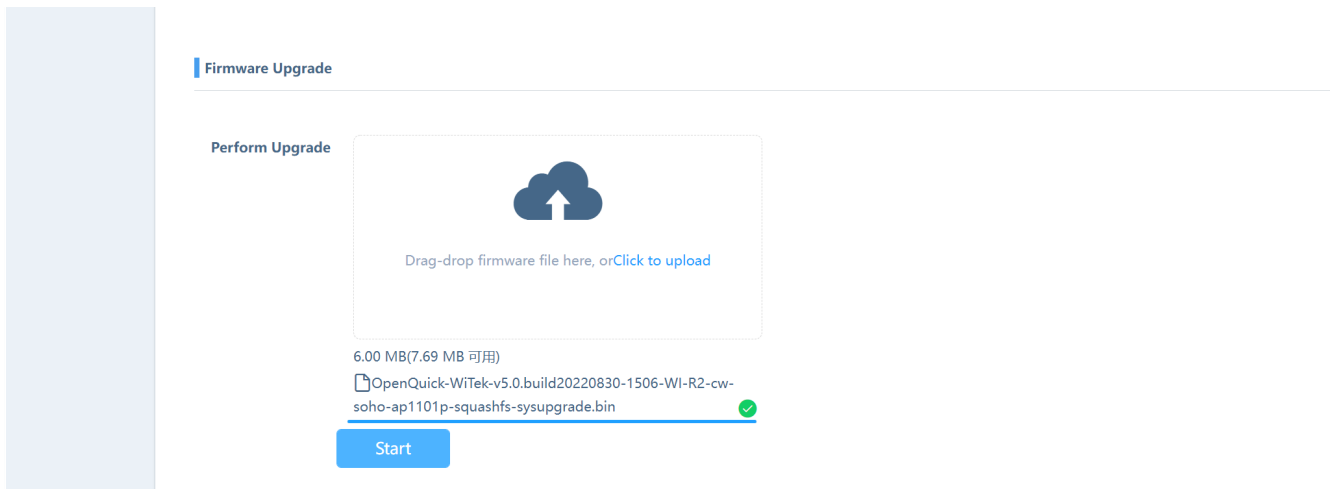

Click the start button to upgrade.

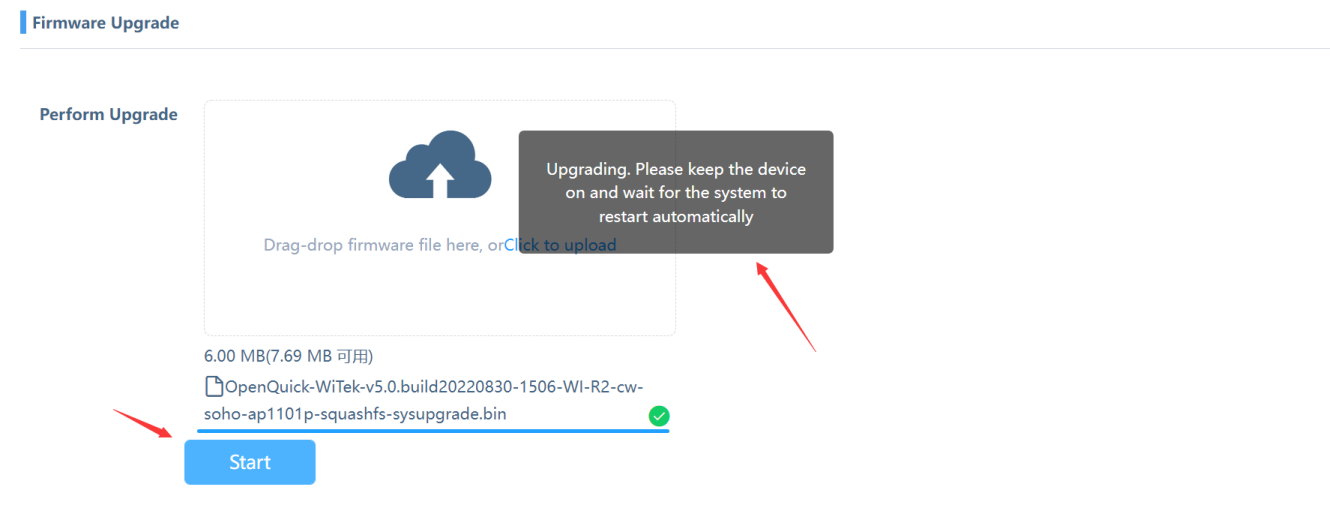

After waiting for 3 minutes, restore it to the factory setting

Default IP: **192.168.1.88**, Default password: **admin**

Re login the interface, and the web interface of the new firmware is as shown in the following figure:

With Mesh Version:

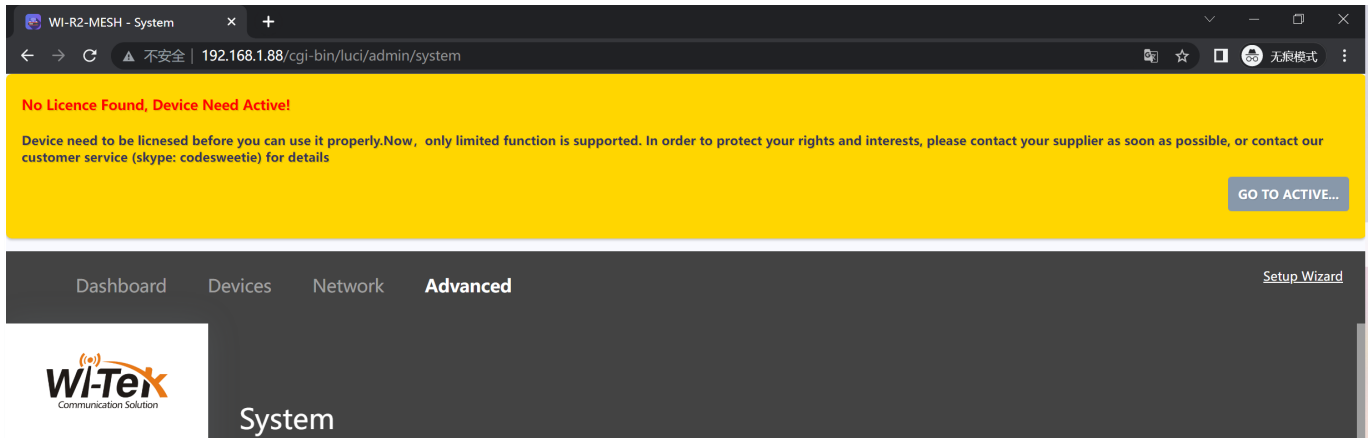

Note: When the device is connected to the Internet, the authorization will be automatically activated.

With AP Version:

